



输出功率：约0.3~8.0W

精密金属齿轮减速电机

典型应用： 智能家居  
智能机器人  
医疗器械  
电动玩具

OUTPUT:APPROX 0.3~8.0W

Precision Metal Gear Motor

Typical Applications: Smart Home  
Smart Robot  
Medical Instruments  
Electric Toys

## 1.OUTLINE DRAWING:

UNIT:MM

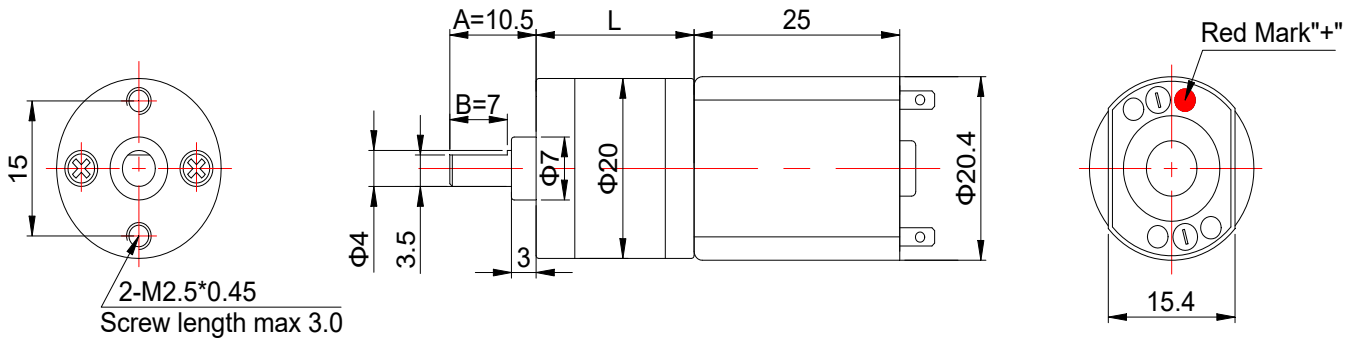

Customizable Parameters:

1. Length L、 A and B
2. Electric Performance
3. Output shaft specifications
4. Reduction Ratio

View:

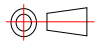

WEIGHT: 50g(Approx)

## 2.GEARBOX REDUCTION RATIO:

Gearbox Length (mm)	Stage Number	Reduction Ratio						Rated Troque	Bearable Maximum Instant Torque
		kg.cm							
16	4	25/1	31/1					1.0	2.5
17.5	5	63/1	78/1					1.5	3.0
19	6	100/1	125/1	156/1	195/1			2.0	5.0
20.5	7	250/1	313/1	390/1	488/1			2.5	6.0

## 3.MOTOR PERFORMANCE :

1N.m≈10.2kg.cm≈14.2oz.in

MODEL	REDUCTION RATIO	VOLTAGE		NO LOAD		AT MAXIMUM EFFICIENCY				STALL	
		OPERATING RANGE	NOMINAL	SPEED	CURRENT	SPEED	CURRENT	TORQUE	OUPUT	TORQUE	CURRENT
			V	rpm	A	rpm	A	kg.cm	W	kg.cm	A
20GA130-25-03200	25/1	2.0~4.0	3.0	200	0.06	150	0.29	0.2	0.31	0.79	0.95
20GA130-78-0364	78/1	2.0~4.0	3.0	64	0.06	50	0.26	0.4	0.21	1.81	0.95
20GA130-100-0350	100/1	2.0~4.0	3.0	50	0.06	40	0.25	0.6	0.25	2.83	0.95
20GA130-31-06435	31/1	3.0~7.0	6.0	435	0.09	365	0.53	0.3	1.12	1.88	2.83
20GA130-100-06135	100/1	3.0~7.0	6.0	135	0.09	115	0.5	0.8	0.94	5.42	2.83
20GA130-156-0686	156/1	3.0~7.0	6.0	86	0.09	75	0.45	1.0	0.77	7.60	2.83
20GA130-250-1230	250/1	5.0~13.0	12.0	30	0.03	21	0.15	1.5	0.32	5.40	0.45
20GA130-488-1215	488/1	5.0~13.0	12.0	15	0.03	11.5	0.13	2.5	0.00	10.54	0.45