



输出功率：约0.3~10.0W

精密金属齿轮减速电机

典型应用： 智能家居  
智能机器人  
医疗器械  
电动玩具

OUTPUT:APPROX 0.3~10.0W

Precision Metal Gear Motor

Typical Applications: Smart Home Appliance  
Smart Robot  
Medical Instruments  
Electric Toys

## 1.OUTLINE DRAWING:

UNIT:MM

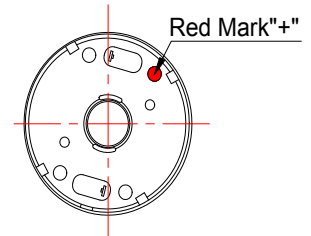
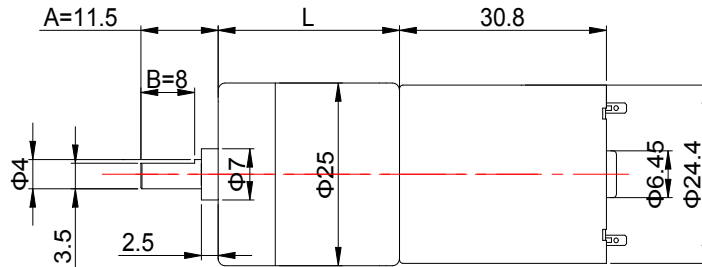
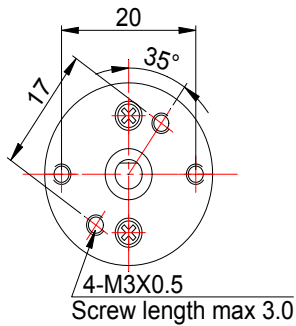

Customizable Parameters:

1. Length L、 A and B
2. Electric Performance
3. Output shaft specifications
4. Reduction Ratio

View:



WEIGHT: 95g(Approx)

## 2.GEARBOX REDUCTION RATIO:

Gearbox Length (mm)	Stage Number	Reduction Ratio						Rated Torque	Bearable Maximum Instant Torque
		kg.cm							
19	4	15.5/1	20.4/1					1.0	3.0
21	5	26/1	30/1	34/1	45/1			2.0	6.0
23	6	57/1	75/1	98/1				2.5	7.0
25	7	125/1	165/1	217/1				3.0	8.0
27	8	274/1	362/1	478/1				3.0	8.0

## 3.MOTOR PERFORMANCE :

1N.m≈10.2kg.cm≈14.2oz.in

MODEL	REDUCTION RATIO	VOLTAGE		NO LOAD		AT MAXIMUM EFFICIENCY				STALL	
		OPERATING RANGE	NOMINAL	SPEED	CURRENT	SPEED	CURRENT	TORQUE	OUTPUT	TORQUE	CURRENT
			V	rpm	A	rpm	A	kg.cm	W	kg.cm	A
25GA370-26-12231	26/1	3.0~12.0	12.0	231	0.09	162	0.43	1.1	1.83	3.7	1.2
25GA370-20.4-12400	20.4/1	3.0~12.0	12.0	400	0.05	340	0.36	0.4	1.39	2.6	2.1
25GA370-98-0650	98/1	3.0~6.0	6.0	50	0.05	41	0.21	1.6	0.67	9.8	1.06
25GA370-165-1288	165/1	3.0~12.0	12.0	88	0.26	43	1.27	6.0	2.65	35.3	6.2
25GA370-478-1207.8	478/1	3.0~12.0	12.0	7.8	0.03	7	0.07	2.0	0.14	19.5	0.52